

	<h2>REAR MASTER CYLINDER</h2>	PS 12 C	
		10.4776.80	D

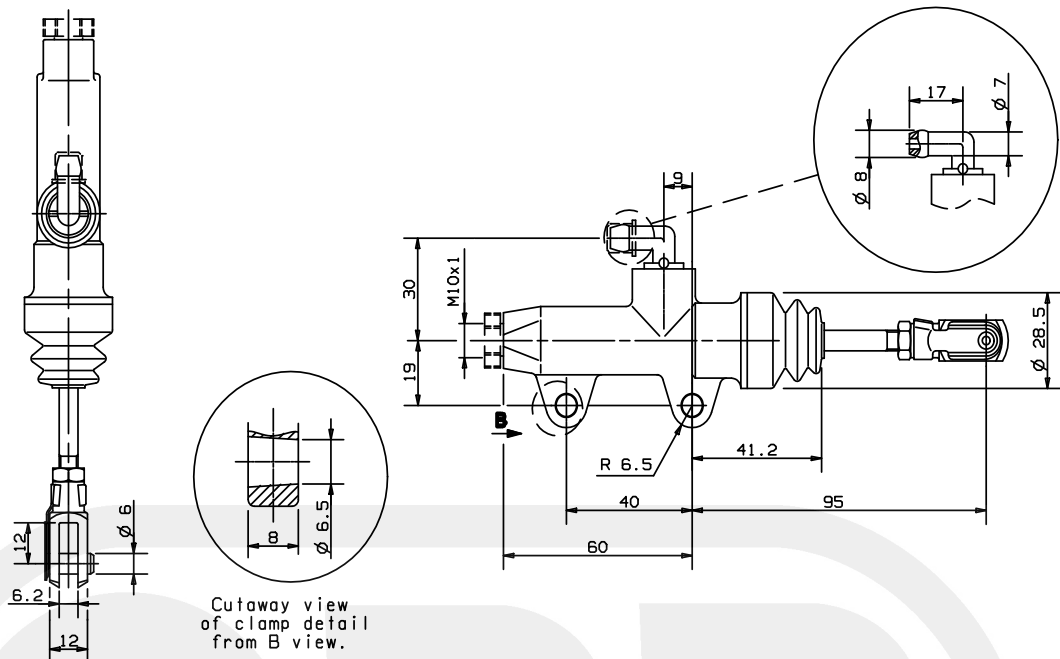

Cutaway view of clamp detail from B view.

DESCRIPTION	
Rear master cylinder with push rod. Construction Material: Aluminium Alloy. Operating fluid: brake fluid DOT4. Pipe fitting can be oriented in the desired position.	Master cylinder BODY color: Black Anodic Oxidation. Master cylinder FORK protection: Dacromet (Aluminium color).

TECHNICAL CHARACTERISTICS	
Piston diameter:	12.0 mm
Piston and push rod clearance with assembled master cylinder:	1.0 mm
Weight:	0.120 Kg
Maximum piston stroke:	9.8 mm

AVAILABLE SPARE PARTS

SPARE PARTS CODE	PIPE FITTING	BOOT	PUSH ROD
10.4776.80	210.3127.20	210.3741.20	110.4266.51

Indicating informations subject to modification.
 For further specifications contact Technical Section.

LAST UPDATE: 05/07/1994