

	<h1>FIXED CALIPER</h1>	P4 30/34 F
		20.6800.16 26 A

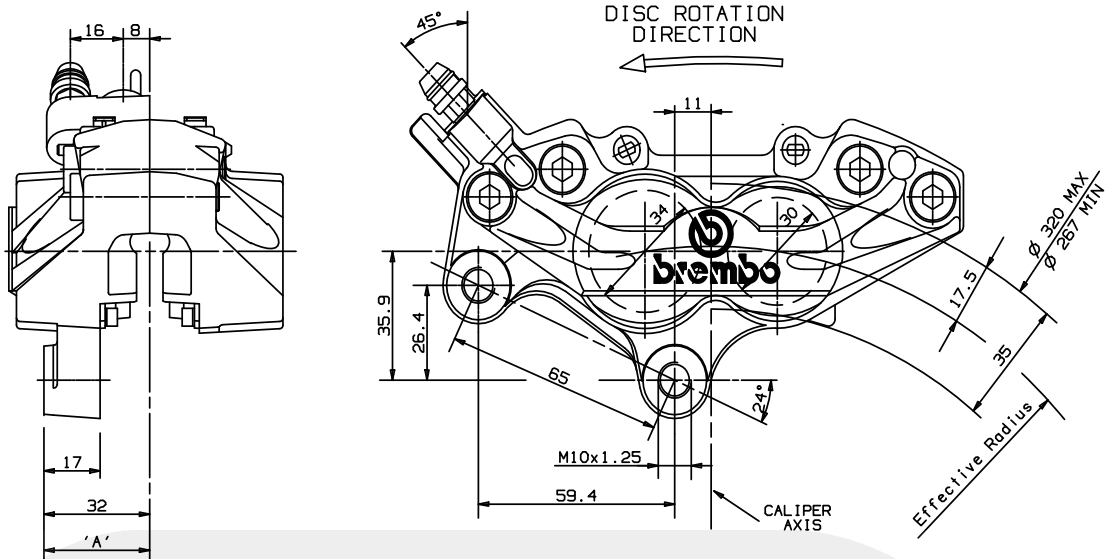

DESCRIPTION

Fixed caliper with 4 opposed pistons, realized by semicalipers joined by bolts. Pads are supported by two pins. Construction Material: Aluminium Alloy. Operating fluid: brake fluid DOT4. N.B.: drawing shows left side caliper. Code 20.6800.16 Code 20.6800.26 specular. Mounting side behind the fork.

PADS SHAPE AND DIMENSIONS

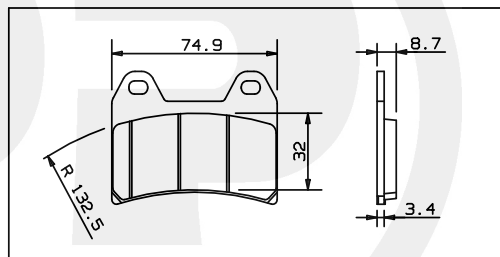

TECHNICAL CHARACTERISTICS

Pistons number and diameter:	4 30/34mm	Average pad surface (1 pad):	22.5 cm ²
MAX working pressure:	70bar	Weight (with sintered pad):	1.090 Kg
A) Disc position (TOLERANCE):			
Disc thickness 5.0 mm	±0.8 mm		
Disc thickness 4.0 mm	±0.8 mm		

CONFIGURATION

CODE CALIPER	CHARACT.	PADS FRICTION MATERIAL	BODY COLOR	MOUNT. SIDE	USABLE DISCS THICKNESS	BRAKE FLUID FOR PADS WEAR
20.6800.16 26		TT 2802 GG TOSHIBA	BLACK	SX DX	5.0 mm 4.0 mm	16 cm ³

AVAILABLE SPARE PARTS

CODE CALIPER	SPARE PARTS	PADS	BLEEDER SCREW	DUST COVER	RETAINERS	PIN/RETAINER	PAD SPRING
20.6800.16 26		107.6708.11	105.3246.14	105.1502.10	105.4542.18	120.3942.30	120.2255.90

Indicating informations subject to modification. For further specifications contact Technical Section.

LAST UPDATE: 28/04/1998