

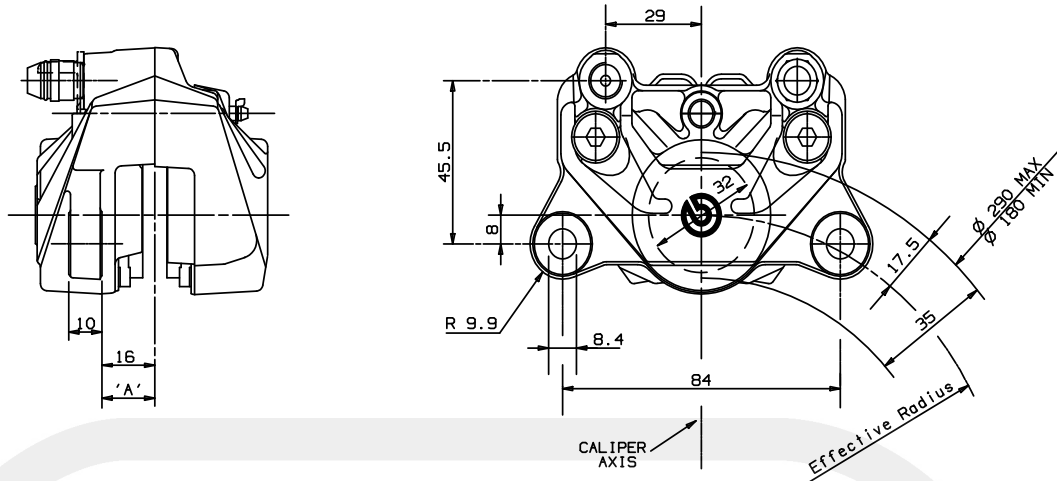

FIXED CALIPER

P 32 G
20.6950.11
.21 C



DESCRIPTION

Fixed caliper with 2 opposed pistons, realized by semicalipers joined by bolts. Pads are supported by one pin. Construction Material: Aluminium Alloy. Operating fluid: brake fluid DOT4.

N.B.: drawing shows caliper Code 20.6950.11
 Caliper Code 20.6950.21 specular.

PADS SHAPE AND DIMENSIONS

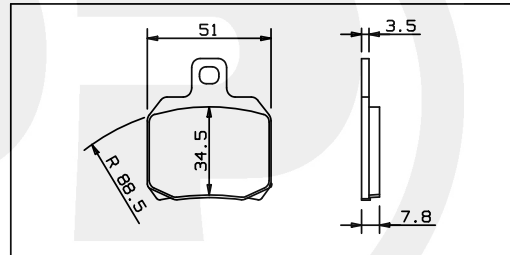

TECHNICAL CHARACTERISTICS

| | | | |
|-------------------------------|---------|----------------------------------|----------------------|
| Pistons number and diameter: | 2 32mm | Average pad surface (1 pad): | 16.1 cm ² |
| MAX working pressure: | 70bar | Weight (with not sintered pads): | 0.600 Kg |
| A) Disc position (TOLERANCE): | ±0.6 mm | | |

CONFIGURATION

| CHARACT. CODE CALIPER | PADS FRICTION MATERIAL | BODY COLOR | MOUNT. SIDE | USABLE DISCS THICKNESS | BRAKE FLUID FOR PADS WEAR |
|-----------------------|------------------------|------------|-------------|------------------------|---------------------------|
| 20.6950.11 .21 | FERIT I/D 450 FF | GOLD | SX DX | 4.0 mm | 6.5 cm ³ |

AVAILABLE SPARE PARTS

| SPARE PARTS CODE CALIPER | PADS | BLEEDER SCREW | DUST COVER | PIN SPLIT SPRING |
|--------------------------|-------------|---------------|-------------|------------------|
| 20.6950.11 .21 | 107.6949.11 | 105.3387.10 | 105.1502.10 | 120.5116.11 |

Indicating informations subject to modification.
 For further specifications contact Technical Section.

LAST UPDATE: 09/02/1999