



General Rear Set Assembly

-Footpeg connects through lever and (heel guard) bracket with included stainless steel bolt and shims.

Use one stainless steel shim on each side of the brake & shift lever.

Apply grease to all bearings & use a thread locking agent on all bolts.

-Note: Rear sets come with 2 different length shift rods. Footpeg position determines which shift rod you will utilize.



Shift Side Installation

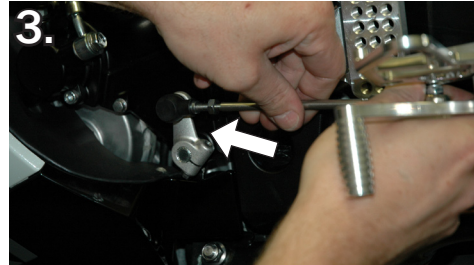
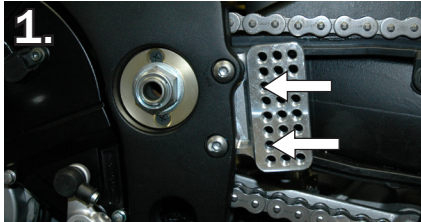

1. Install relocator bracket as shown. Arrows identify holes for stock positioning.
2. Your kit includes two shift rods. The shorter is for positions that are closer to the front of the bike. Install a nut on both sides of the shift rod that you have determined that you will be using and thread them all the way in by hand.
3. Install the shift bracket assembly onto the relocator (shown below). Then adjust the shift rod until the desired shift lever position is achieved. Tighten the jam nuts on the shift rod.
4. Install the shift lever and footpeg onto the shift bracket using the special bolt and washer included in the kit. Hold the shift side assembly so that you can thread the shift rod into both the knuckle on the engine and the heim joint on the shift lever at the same time. The side of the shift rod with reverse threads will connect to the shift lever.

Reverse (GP) Shift Adjustment

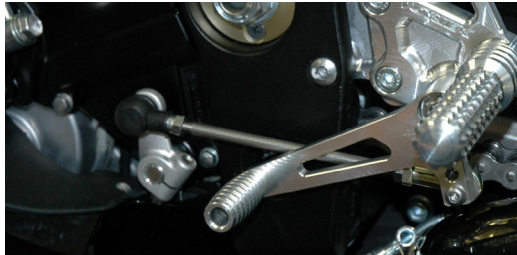

Standard Shift



Reverse Shift

Vortex rear sets can easily be converted to reverse (GP) shifting if preferred.

1. Remove pinch bolt in shift knuckle
2. Invert shift knuckle 180 degrees
3. Modify angle as needed for perfect positioning
4. Tighten pinch bolt to factory specs.

Brake Side Installation

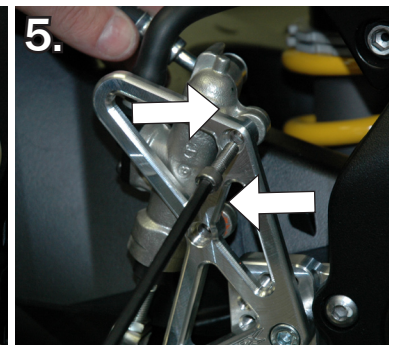
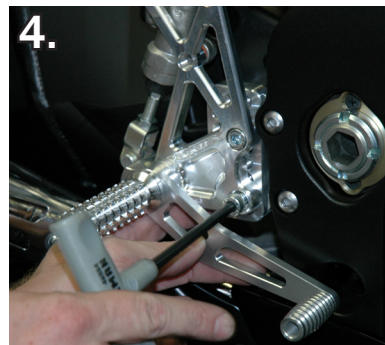
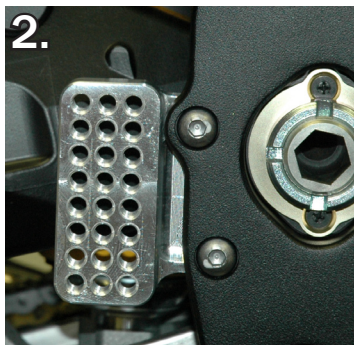
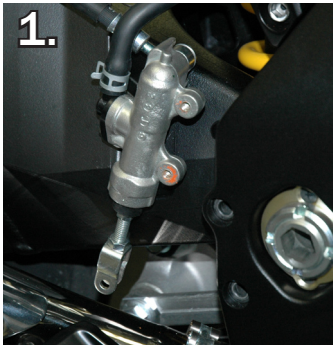

1. Remove the rear master cylinder from the stock rearsets and then remove the rearsets from the bike. You do NOT need to open up the hydraulic system on the rear brake to do this.
2. Install the relocator bracket onto the frame. Stock position mounting holes are indicated by arrows.
3. Install the brake lever and footpeg onto the brake bracket (see 'general rear set assembly' diagram at top of page).
4. Install the finished brake bracket assembly onto the relocator.
5. Install the master cylinder onto the brake bracket using the new bolts supplied in the kit. Use the stock hardware to attach the master cylinder to the brake lever.

*Although VORTEX Rear-Sets are designed for race use, if you would like to retain rear brake light functionality from the rear brake lever please order the in-line pressure switch, VORTEX Part #RS100

CHECK ALL NUTS, BOLTS AND FUNCTION OF BRAKE SYSTEM PRIOR TO RIDING MOTORCYCLE