

Box: PLOCK 3

BIKE	APRILIA RSV4	PART NO.	AP-1000
YEAR	2009 - ON	FIT KITS	ROUND Z039.10391
NOTES	Use standard fittings where not supplied	FEATURES	DB KILLER Z028.20129

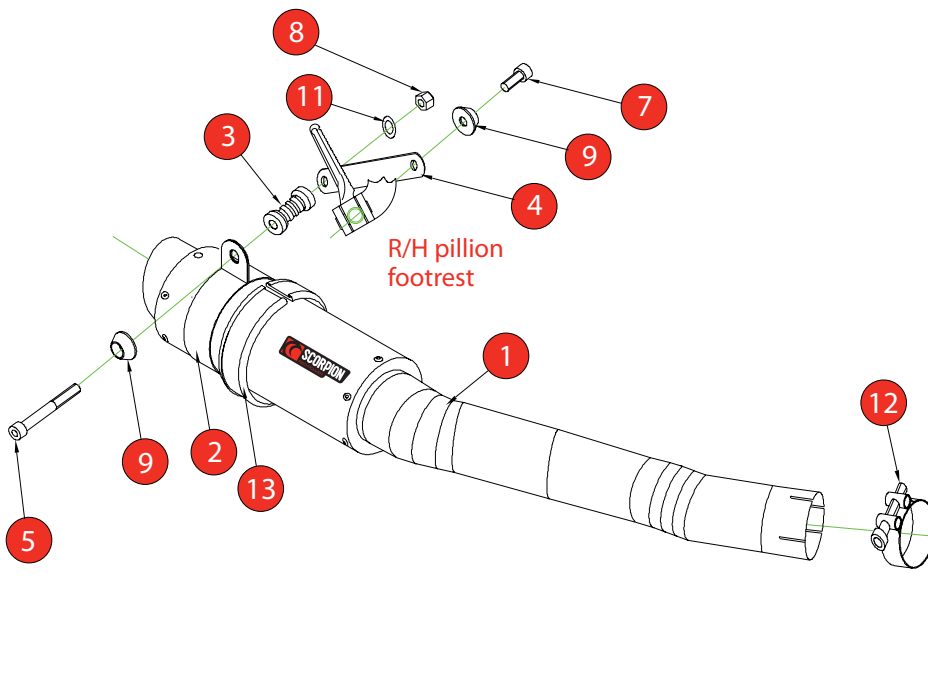

1 225mm RP-1 GP Silencer SC160 with integrated CP 574	8 2 x M8 Nyloc nuts (Z017.10062)
2 Titanium silencer strap (Z028.10013)	9 3 x bolt finishers (Z026.20068)
3 Spacer (Z026.20099)	10 M8 x 25mm washer (Z017.10825)
4 Bracket (z015.10074)	11 M8 x 17mm washer (Z017.10831)
5 M8 x 70mm cap head bolt (Z017.10082)	12 55-59mm band clamp (Z016.10004)
6 M8 x 30mm cap head bolt (Z017.10074)	13 Square edge rubber 275mm (Z029.10024)
7 M8 x 20mm cap head bolt (Z017.10072)	

E-MARK	BSAU 193a 1990/t3
ISSUE NO.	3
DATE	24/06/11
AUTHORISED	S.PEPPER
CHECKED	

NOTE: ENSURE SCORPION SYSTEM IS CLEAR OF MOVING PARTS AND ALL ORIGINAL FUNCTIONS WORK CORRECTLY.



A) Remove original exhaust from bike, taking care to keep all original components in a safe place.

B) Refit Scorpion exhaust as per line diagram above.

C) When fitted take bike for a short ride to ensure all functions are correct.

D) When bike & exhaust are cool enough check all nuts and bolts are still secure.

